

COUNTY RD 20

COUNTY RD 50

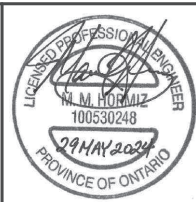

RC SPENCER ASSOCIATES INC.
 Consulting Engineers
 Windsor: 800 University Avenue W., Windsor ON N9A 5R9
 Leamington: 18 Talbot Street W., Leamington ON N8H 1M4
 Chatham-Kent: 49 Raleigh Street - Chatham ON N7M 2M6

Professional Engineers
 Ontario

NO.	REVISION	DATE	BY	APP	SCALE
3.	REVISED PER LATEST SITE PLAN	29 MAY 2024	M.M.H.	A.D.B.	1:250
2.	SUBMIT FOR APPROVAL	21 MAR. 2024	M.M.H.	A.D.B.	
1.	SUBMIT TO CLIENT FOR REVIEW	6 MAR. 2024	M.M.H.	A.D.B.	

DESIGN M.M.H.
 CHECKED A.D.B.
 DRAWN M.M.H.
 CHECKED A.D.B.
 DATE
 SCALE 1:250

SWEPT PATH ANALYSIS – 6754 CR50 MALDEN CENTRE

ENTRANCE FROM CR20 & RIGHT TURN EGRESS ONTO CR50 (13.9m FUEL TANKER)

PROJECT NO. 24-1557
 FIGURE NO. 1
 OF 2

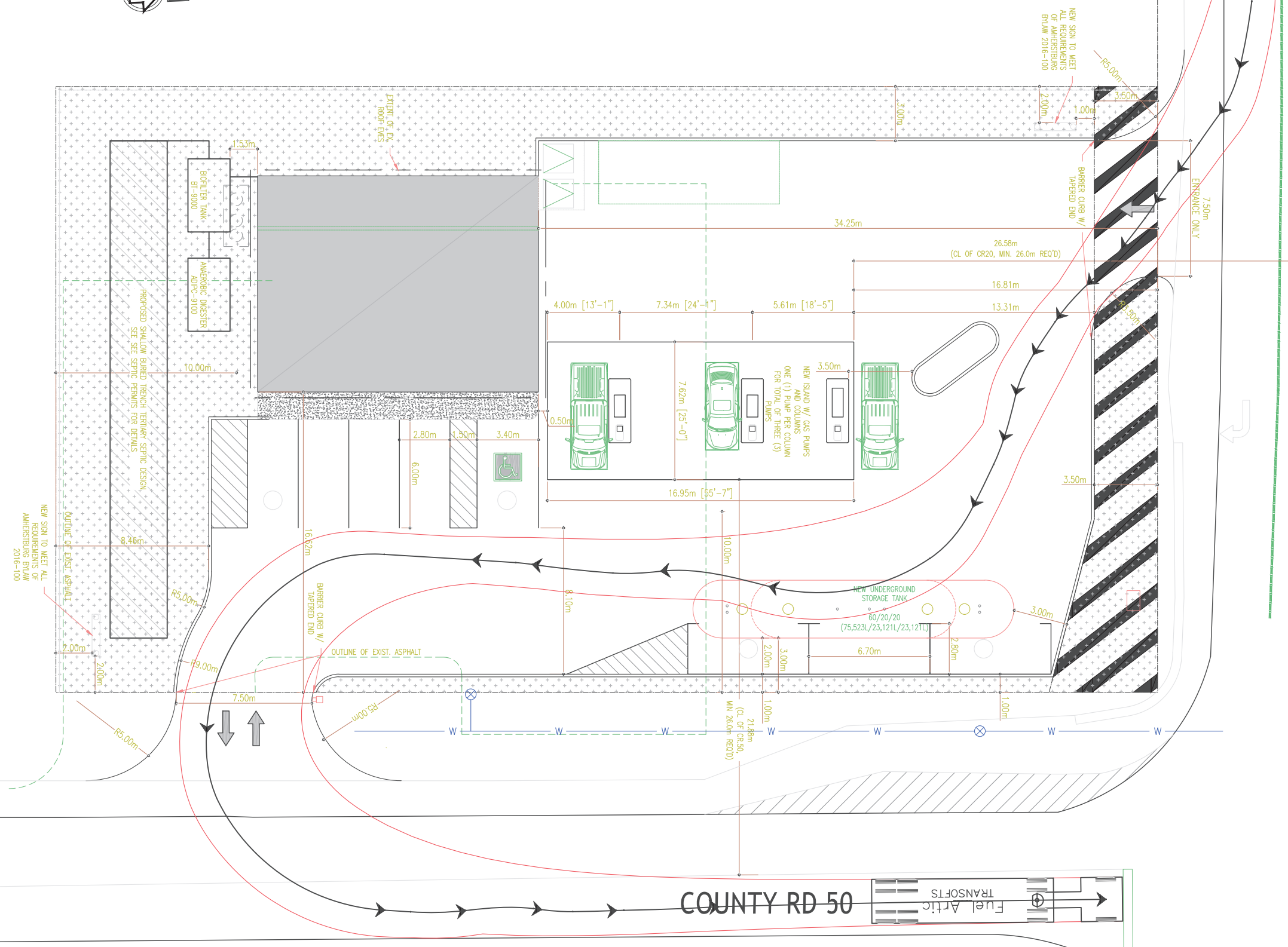

COUNTY RD 20

COUNTY RD 50
Fuel Artic TRANSOFTS

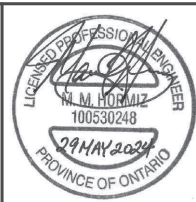

RC SPENCER ASSOCIATES INC.
Consulting Engineers
Windsor: 800 University Avenue W., Windsor ON N9A 5R9
Leamington: 18 Talbot Street W., Leamington ON N8H 1M4
Chatham-Kent: 49 Raleigh Street - Chatham ON N7M 2M6

Professional Engineers
Ontario

NO.	REVISION	DATE	BY	APP	SCALE
3.	REVISED PER LATEST SITE PLAN	29 MAY 2024	M.M.H.	A.D.B.	1:250
2.	SUBMIT FOR APPROVAL	21 MAR. 2024	M.M.H.	A.D.B.	
1.	SUBMIT TO CLIENT FOR REVIEW	6 MAR. 2024	M.M.H.	A.D.B.	

DESIGN M.M.H.
CHECKED A.D.B.
DRAWN M.M.H.
CHECKED A.D.B.
DATE
SCALE 1:250

SWEPT PATH ANALYSIS - 6754 CR50 MALDEN CENTRE

**LEFT TURN EGRESS ONTO CR50
(13.9m FUEL TANKER)**

PROJECT NO.
24-1557

FIGURE NO.
2

OF
2