



**TOWN OF AMHERSTBURG  
ACCESSIBILITY ADVISORY COMMITTEE MEETING**

**AGENDA**

**View Livestream at the time of the proceedings at  
<https://www.amherstburg.ca/livestream>**

**Council Chambers  
271 Sandwich Street South, Amherstburg, ON, N9V 2A5**

**Wednesday, April 2, 2025**

**5:00 PM**

For information pertaining to this agenda or to arrange for any additional accessibility needs please contact [accessibility@amherstburg.ca](mailto:accessibility@amherstburg.ca).

Information will be gathered in accordance with the Municipal Freedom of Information and Protection of Privacy Act (MFIPPA). All comments and communications received will become part of the public record unless you expressly request the Town to remove it. If you want to learn more about why and how the Town collects your information, write to the Town Clerk's Office, 271 Sandwich Street South, Amherstburg, ON N9V 2A5 or call 519-736-0012.

---

**Pages**

- 1. CALL TO ORDER**
- 2. ROLL CALL**
- 3. DISCLOSURE OF PECUNIARY INTEREST & GENERAL NATURE THEREOF**
- 4. LAND ACKNOWLEDGMENT**

We will begin by acknowledging that the land on which we gather is the traditional territory of the Three Fires Confederacy of First Nations (comprising the Ojibway, the Odawa, and the Potawatomie Peoples), and of the Huron-Wendat and Wyandot Peoples. We recognize the land as an expression of gratitude to those whose traditional territory we reside on, and a way of honouring the Indigenous people who have been living and thriving on the land since time immemorial. We value the significant historical and contemporary contributions of local and regional First Nations and all of the Original Peoples of Turtle Island.

## **5. MINUTES OF PREVIOUS MEETING**

<b>5.1 Amherstburg Accessibility Advisory Committee Meeting Minutes - January 23, 2025</b>	<b>3</b>
--	----------

## **6. ORDER OF BUSINESS**

<b>6.1 Co-An Park Inclusive Playground Design</b>	<b>7</b>
<b>6.2 Malden Park RFP for New Accessible Playground</b>	<b>14</b>
<b>6.3 Jack Purdie Park RFP for Multi Use Trail</b>	<b>18</b>
<b>6.4 Fest-For-All Update</b>	

## **7. UNFINISHED BUSINESS**

## **8. NEW BUSINESS**

## **9. ADJOURNMENT**

That the Committee **ADJOURN** at \_\_\_\_\_ p.m.



**TOWN OF AMHERSTBURG**  
**ACCESSIBILITY ADVISORY COMMITTEE MEETING**  
**MINUTES**

**Thursday, January 23, 2025**

**5:00 P.M.**

**Council Chambers**

**271 Sandwich Street South, Amherstburg, ON, N9V 2A5**

PRESENT                      Shirley Curson-Prue - Chair  
                                      Tony Pietrangelo - Vice Chair  
                                      Councillor Donald McArthur  
                                      Marc Renaud  
                                      Christopher Drew  
                                      Christine Easterbrook (*Electronic Participant*)  
                                      William Whittall

STAFF PRESENT              Kevin Fox - Staff Liaison, Clerk  
                                      Selena Scebba - Recording Secretary

---

**1. CALL TO ORDER**

The Recording Secretary called the meeting to order at 5:00 p.m.

**2. ROLL CALL**

**3. CALL FOR NOMINATIONS**

### 3.1 **Nomination of Chair**

**Moved by** T. Pietrangelo

**Seconded by** C. Drew

That Shirley Curson-Prue **BE APPOINTED** Chair of the Amherstburg Accessibility Advisory Committee.

The Recording Secretary put the motion.

**Motion Carried**

### 3.2 **Nomination of Vice Chair**

**Moved by** S. Curson-Prue

**Seconded by** C. Drew

That Tony Pietrangelo **BE APPOINTED** Vice Chair of the Amherstburg Accessibility Advisory Committee.

The Recording Secretary put the motion.

**Motion Carried**

*The Chair assumed control of the meeting.*

## 4. **DISCLOSURE OF PECUNIARY INTEREST & GENERAL NATURE THEREOF**

*There were no disclosures noted.*

## 5. **LAND ACKNOWLEDGMENT**

The following land acknowledgment was read, “We will begin by acknowledging that the land on which we gather is the traditional territory of the Three Fires Confederacy of First Nations (comprising the Ojibway, the Odawa, and the Potawatomie Peoples), and of the Huron-Wendat and Wyandot Peoples. We recognize the land as an expression of gratitude to those whose traditional territory we reside on, and a way of honouring the Indigenous people who have been living and thriving on the land since time immemorial. We value the significant historical and contemporary contributions of local and regional First Nations and all of the Original Peoples of Turtle Island.”

**6. MINUTES OF PREVIOUS MEETING**

**6.1 Amherstburg Accessibility Advisory Committee Meeting Minutes - December 5, 2024**

**Moved by** C. Drew

**Seconded by** Councillor McArthur

That the Amherstburg Accessibility Advisory Committee meeting minutes of December 5, 2024 **BE ADOPTED**.

The Chair put the motion.

**Motion Carried**

**7. ORDER OF BUSINESS**

**7.1 Amherstburg Accessibility Advisory Committee Meeting Schedule for 2025**

**Moved by** T. Pietrangelo

**Seconded by** Councillor McArthur

That the proposed 2025 Amherstburg Accessibility Advisory Committee Meeting Schedule **BE ADOPTED**.

The Chair put the motion.

**Motion Carried**

**7.2 Parks Master Plan 2025 Consultation**

**7.3 Site Plan Review - 6754 County Road 50**

**Moved by** C. Drew

**Seconded by** T. Pietrangelo

That the site plan for 6754 County Road 50 **BE RECEIVED**.

The Chair put the motion.

**Motion Carried**

**Moved by** T. Pietrangelo

**Seconded by** C. Drew

That the Amherstburg Accessibility Advisory Committee **RECOMMEND** to Administration that the site plan for 6754 County Road 50 include the following elements:

1. The signage for the accessible parking space be amended to note it as being “Van Accessible” in compliance with section 80.34 of the Integrated Accessibility Standards Regulation;
2. The site plan include a tactile surface indicator plate at the ramp access adjacent to the barrier free route of travel for the access aisle; and,
3. The placement of accessible parking space be adjacent to the entry into the facility.

The Chair put the motion.

**Motion Carried**

**8. UNFINISHED BUSINESS**

**9. NEW BUSINESS**

**10. ADJOURNMENT**

**Moved by** C. Drew

**Seconded by** M. Renaud

That the Committee **ADJOURN** at 6:18 p.m.

The Chair put the motion.

**Motion Carried**

---

Shirley Curson-Prue - Chair

---

Selena Scebba - Recording Secretary



## Report to Council

Department: Community Services  
Division: Parks and Facilities  
Date: March 3, 2025  
Prepared by: Jake Morassut, Director Community Services  
Report Number: Parks and Facilities-2025-03  
Subject: Results of Request for Proposal – Design, Supply, and Install Playground Equipment for Co-An Park  
Number of Pages: 5

### Recommendation(s)

**That** Parks and Facilities Report 2025-03 entitled “Results of Request for Proposal – Design, Supply, and Install Playground Equipment for Co-An” be received; and

**That** Council award the Request for Proposal to Design, Supply, and Install Playground Equipment for Co-An Park to New World Park Solutions Inc in the amount of \$389,791.00 (including non-refundable tax), with 50% funded from the Town of Amherstburg.

### Purpose

In accordance with the Town Procurement By-Law Number 2129, Council approval is required for purchases where the total contract price is more than \$300,000.00. This report is to seek Council’s approval to appoint a qualified supplier, to design, supply, and install new playground equipment at Co-An Park in McGregor.

## Background and Discussion

A request for Proposal following the guidelines set out in the Town's Procurement By-Law Number 2129 for a new Co-An Park playground was posted both on the Town's website and Bids and Tenders. The RFP closed on January 22, 2025, at 3:00 PM.

The proposals received were evaluated using a scorecard approach, taking into consideration the experience with similar projects, understanding of the proposal scope and quality of the proposal, design, age appropriateness features, accessible features, equipment warranties and public opinion, based on a fixed budget of up to \$390,000.00, including non-refundable taxes. As Co-An Park is co-owned with the Town of Amherstburg, 50% of the cost of the playground will be paid for by the Town of Amherstburg.

The proposal review process included the public opinion, and an administrative review team made up of:

- i. Jackson Tang, Assistant Manager, Finance and Business Services,
- ii. Jake Morassut, Director, Community Services,
- iii. Rodney Klie, Manager, Parks and Facilities,
- iv. Stephen Hayes, Technical Support Project Manager (Town of Amherstburg); and
- v. Annette Zahaluk, Manager, Parks and Naturalized Areas (Town of Amherstburg).

Three companies, each providing two designs, were received upon closing of the RFP. The submitted playgrounds were reviewed to ensure they met the requirements of the RFP and evaluated based on the evaluation criteria. Four of the six designs were ranked high enough to qualify for the public feedback.

To obtain public input the Town of Essex held a two-week virtual vote held from February 7<sup>th</sup> to February 21<sup>st</sup>, 2025, to allow the public to review and rank four designs. There was a total of 859 online votes with New World Park Solutions Inc's Option 2 receiving the most votes.



After reviewing each proposal as submitted and totaling all the criteria scores, “New World Park Solutions Inc.’s - Option 2” is recommended as the option for the new Co-An Park Playground equipment (see Appendix A). New World Park Solutions Inc. addressed all areas of the scope as identified in the request for proposal.

## **Financial Impact**

A total of \$400,000.00, 50% funded from the Town of Amherstburg, was approved in the 2024 Community Services capital budget for this park and playground project as Capital Project CS-24-0012 as the “Co-An Park Playground”.

New World Park Solution’s Inc. bid proposal of \$389,791.00, inclusive of non-refundable tax, is within the allocated budget for the new playground. The net financial impact to the Town of Essex is \$194,895.50 as the Town of Amherstburg will pay 50% of the total cost.

## **Consultations**

Rodney Klie, Manager, Parks/Facilities

Kate Giurissevich, Director, Corporate Services/Treasurer

Jackson Tang, Assistant Manager, Finance and Business Services

Stephen Hayes, Technical Support Project Manager (Town of Amherstburg)

Annette Zahaluk, Manager, Parks and Naturalized Areas (Town of Amherstburg)

## Appendix 'A' New World Park Solutions Inc. – Option 2 Design



### Link to Strategic Priorities

- Embrace asset management best practices to build, maintain, and continuously improve our municipally owned infrastructure.
- Leverage our Town's competitive advantages to promote jobs and economic investment.
- Take care of our natural environment and strengthen the sense of belonging to everyone who makes Essex "home".
- Deliver friendly customer service in an efficient, effective, and transparent manner while providing an exceptional working environment for our employees.
- Build corporate-level and community-level climate resilience through community engagement and partnership and corporate objectives.



## Report Approval Details

Document Title:	Awarding of RFP for Co-An Park Playground - Parks and Facilities-2025-03.docx
Attachments:	
Final Approval Date:	Feb 25, 2025

This report and all of its attachments were approved and signed as outlined below:



**Kate Giurissevich, Director, Corporate Services - Feb 25, 2025 - 9:46 AM**

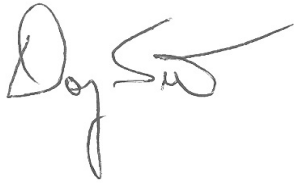

**Doug Sweet, Chief Administrative Officer - Feb 25, 2025 - 9:48 AM**

**\*\*FULLY INCLUSIVE\*\* - 3rd Party Certified**



NEW WORLD PARK SOLUTIONS  
42 Woodway Trail  
Brantford, ON N3R 6G7

EQUIPMENT SIZE:  
**10M x 8,4M x 5,5M**

USE ZONE:  
**15,86M x 32,37M**

AREA: **401,3 SqM**      PERIMETER: **81M**

FALL HEIGHT:  
**3,4M**

USER CAPACITY: **113**      AGE GROUP: **18mo-12yr**

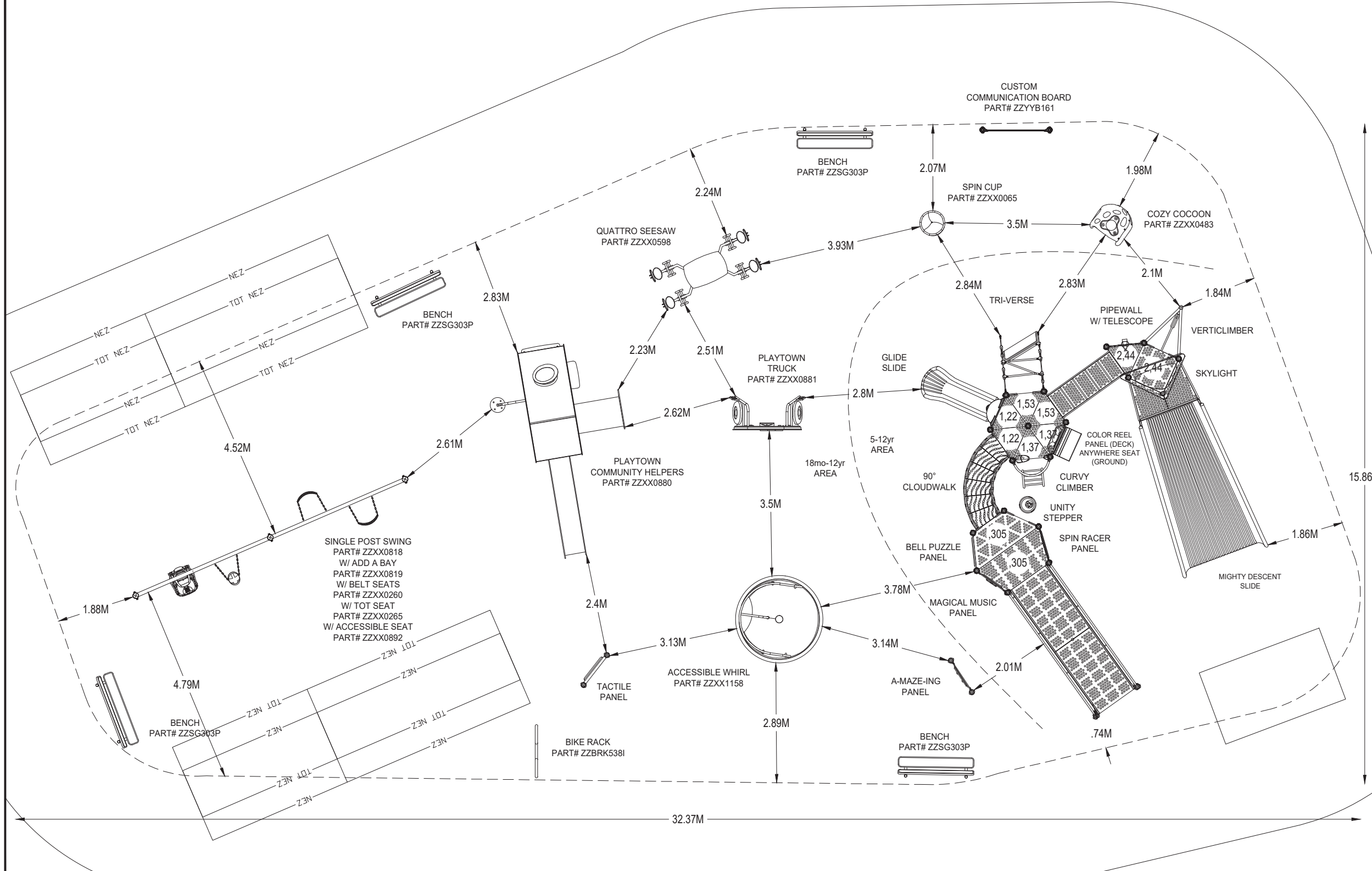

**CO-AN PARK OPTION 2**

ADA SCHEDULE	Total Elevated Play Activities: 12	
	Accessible Elevated Activities	Accessible Ground-Level Play Types
Required	6	3
Provided	12	6

✓ CSA Z614-20

PROJECT NO: <b>24-15614A</b>	SCALE: <b>1:100</b>
DRAWN BY: <b>JESSE HOUSER</b>	Paper Size <b>B</b>
DATE: <b>20-DEC-2024</b>	

\*PLAYGROUND SUPERVISION REQUIRED

## APPENDIX B - PLAYGROUND DESIGN REQUIREMENTS

Playground maximum size requirements are listed on the drawing attached. This is only an outline and guide as the playground boundary can take on any shape so long as the overall sq. ft. area does not exceed 5000sf.

- Sports Baseball or Farm theme for Malden Centre Park Approx. 5000 sf
- Non-themed playground for Malden Centre Park Approx. 5000sf

The playground should include the following components:

- The playground that is themed should be Baseball / sports or Farm theme
- The playground should have EPDM or TPV rubber surfacing, rainbow turf or Soft surface tiles. All rubber surfacing must meet the minimum specifications as outlined in this RFP and should be warrantied for a period of 10 years.
- The playground design must be accessible meeting current AODA Annex H requirements. Designs that have a balance number of ground events to upper level events are encouraged to facilitate interaction.
- Welcome Sign
- 4 Benches
- 1 - 4 loop Bike Rack
- Roof Component
- Slides
- Swings including 1 accessible swing seat

NOTE: Proponents are encouraged to be as creative as possible with their designs. The Town is placing emphasis on proposals that maximize play value, provide variety, challenge and stimulate imagination.

1. Playground Drawings – Aerial Map with playground location/ Base Plan with Maximum Size Requirements:

a) **Malden Centre Park- Baseball Sports or Farm theme and Non-Theme**

- i. Aerial Map Malden Centre Park with Playground location
- ii. Base Plan Malden Centre Park – Playground Boundary (Maximum Size Requirements)
- iii. Swings – 2 baby swings
- iv. 1 big multi person swing **or** 2 belt swings and 1 accessible swing bay
- v. Playground shall have an area for both 18 months to 5 years and 5 years to 12 years, in same pit

2. Playground Pit Details

- a) Playground Pit
- b) Playground Stringer/ Footing

3. Example of Play Events Submission photos or pictures

4. Example of Table for Warranty Items



**MALDEN CENTRE PARK - 5460 County Rd 20**  
**AERIAL MAP with PLAYGROUND LOCATION**  
FEBRUARY 2025

**Appendix 'B'**  
**2025-004**  
N.T.S.

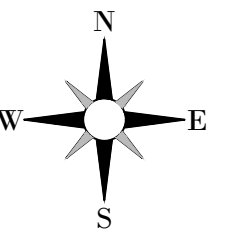

**\* NOTES**  
 PLAYGROUND LIMITS AND DIMENSIONS SHOWN ARE FOR PLAYGROUND DESIGN PURPOSES ONLY. PLAYGROUND CURBS AND EQUIPMENT TO BE LAID OUT IN FIELD BY TOTAL STATION SURVEY TO ENSURE EQUIPMENT CLEARANCES ARE MAINTAINED. FINISHED GRADE OF PERIMETER SIDEWALK AND CURB TO BE 100mm TO 150mm ABOVE SURROUNDING GRANULAR ELEVATION. SUPPLY COMPACTED GRANULAR 'A' TO MATCH GRADE. DRAIN TILE LOCATION & DEPTH IS APPROXIMATE ONLY.

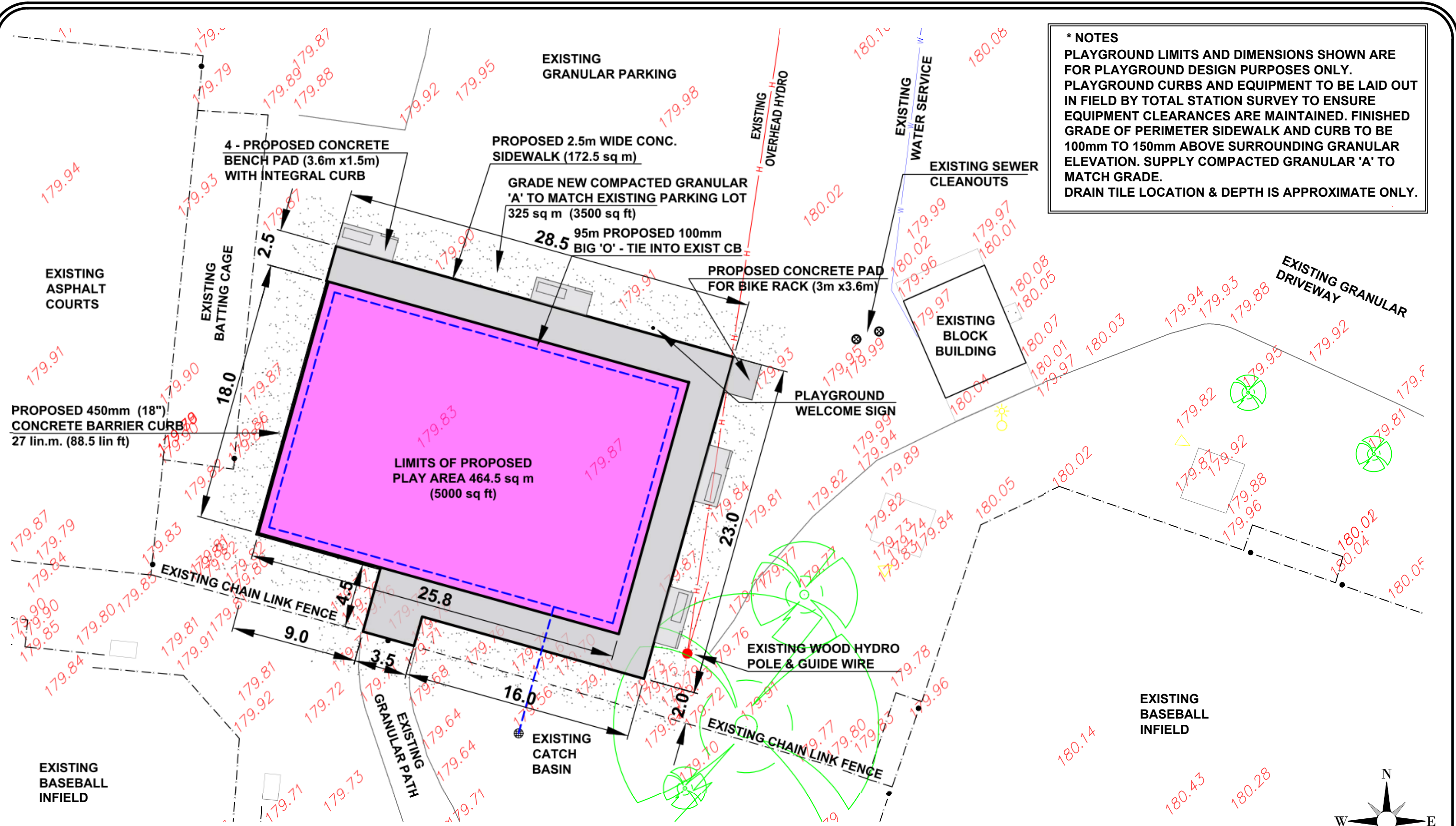

**MALDEN CENTRE PARK - 5460 County Rd 20**  
**LIMITS OF PROPOSED PLAYGROUND**  
 FEBRUARY 2025

**Appendix 'B'**  
**2025-004**  
 N.T.S.

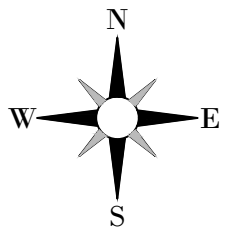



EXAMPLE OF PLAY EVENTS SUBMISSION

SHEET: PARK NAME – Play events

Play Event Name



Play Event Name



Play Event Name



Play Event Name



Play Event Name





**LEGEND**

- EXISTING ASPHALT AND GRANULAR BASE TO BE REMOVED
- EXCAVATION FOR NEW PATHWAY, TOPSOIL TO REMAIN ON SITE

**GENERAL NOTES**

1. CONTRACTOR TO CALL FOR LOCATES PRIOR TO COMMENCEMENT OF ANY WORK ON SITE. CONTRACTOR TO DETERMINE AND VERIFY THE LOCATION AND EXISTENCE OF ALL UNDERGROUND UTILITIES PRIOR TO COMMENCING CONSTRUCTION. ADVISE THE PROJECT MANAGER OF ANY CONFLICTS BETWEEN EXISTING UTILITIES AND NEW WORK.
  2. THE LOCATION OF UTILITIES, IF INDICATED ON THE DRAWING IS NOT CERTIFIED TO BE ACCURATE. THE OWNER LIES ON THE CONTRACTOR AFTER ACCEPTANCE OF ANY CONTRACT AWARD, TO OBTAIN AT THEIR OWN EXPENSE, THE EXACT LOCATION OF EACH UTILITY. NO EXTRAS TO THE CONTRACTOR OR CLAIM FOR COMPENSATION WILL BE ALLOWED IF IT SHOULD BE DISCOVERED THAT ANY UTILITY IS ACTUALLY LOCATED IN THE SITE, LINE OR GRADE THAT IS IN VARIANCE WITH THE SITE, LINE OR GRADE SHOWN ON THIS DRAWING.
  3. CONTRACTOR TO INFORM THE TOWN OF AMHERSTBURG PROJECT MANAGER OF COMMENCEMENT OF WORK, DATE AND THE TIME OF WORK START UP, PRIOR TO ANY ON SITE OPERATIONS TAKING PLACE. THE TOWN'S PROJECT MANAGER WILL MEET THE CONTRACTOR ON SITE TO REVIEW ALL WORK PRIOR TO COMMENCEMENT. A MINIMUM OF 48 HOURS' NOTICE SHALL BE GIVEN TO THE TOWN PRIOR TO STARTING ANY WORK.
  4. THE CONTRACTOR SHALL VERIFY ALL PROPOSED FINISHED GRADES, INCLUDING OF ASPHALT, CONCRETE, INVERTS, CATCH BASINS, AND MANHOLE TOP ELEVATIONS. CONTRACTOR SHALL ENSURE POSITIVE DRAINAGE WITH SLOPES INDICATED ON DRAWINGS. WHERE SLOPES ARE NOT INDICATED, CONTRACTOR SHALL CONSULT WITH THE TOWN ON SITE TO DETERMINE APPROPRIATE GRADE. CONTRACTOR TO OBTAIN ALL PERMITS REQUIRED FOR ANY DRAINAGE WORK, IF NECESSARY.
  5. CONTRACTOR SHALL REPAIR, AT THEIR OWN EXPENSE, ANY DAMAGE CAUSED AS A RESULT OF CONSTRUCTION. VERIFY THAT ALL EXISTING SITE CONDITIONS ARE AS SHOWN ON THE PLANS. THE CONTRACTOR IS RESPONSIBLE TO THE TOWN FOR ANY DAMAGE DONE TO A UTILITY THROUGH ANY ACT OF NEGLIGENCE BY THE CONTRACTOR OR ANYONE ACTING UNDER THE AUTHORITY OF THE CONTRACTOR.
  6. ALL WORK PERFORMED SHALL BE IN COMPLIANCE WITH THE HEALTH AND SAFETY ACT LATEST REVISIONS, AS WELL AS THE TOWN OF AMHERSTBURG HEALTH AND SAFETY POLICIES AND PROCEDURES.
  7. ALL NEW CONCRETE BARRIER CURBS TO CONFORM WITH THE TOWN OF AMHERSTBURG STANDARDS, AND AS PER DRAWINGS. ALL CONCRETE WORK TO CONFORM WITH THE TOWN OF AMHERSTBURG STANDARDS. ALL SLOPES MUST MEET OR EXCEED TOWN OF AMHERSTBURG FADS AND ACDA REGULATIONS.
  8. RESTORATION OF ANY AREAS DISTURBED AS A RESULT OF CONSTRUCTION WILL BE THE RESPONSIBILITY OF THE CONTRACTOR TO RESTORE TO ORIGINAL CONDITIONS OR BETTER, INCLUDING ASPHALT, CONCRETE, CURBS, GRASS OR ANY OTHER SITE FEATURE DAMAGED AS A RESULT OF CONSTRUCTION OPERATIONS. GRASS AREAS TO BE RESTORED WITH FINE GRADED TOPSOIL AND HYDROSEED AS PER SPECIFICATIONS.
  9. GRADES AND DIMENSIONS ARE PROVIDED FOR CONVENIENCE TO BIDDERS AND ARE THE RESPONSIBILITY OF THE CONTRACTOR TO PROVIDE OR VERIFY WITH THE TOWN PROJECT MANAGER.
  10. CONTRACTOR TO PROVIDE SITE LAYOUT SERVICES BY CERTIFIED SURVEYOR TO CONFORM WITH DRAWINGS AND CAD FILES PROVIDED BY THE TOWN. GRADES AND DEPTH MUST BE CONFIRMED BY THE TOWN PROJECT MANAGER PRIOR TO POURING ANY CONCRETE, PLACEMENT OF ASPHALT, OR FINALIZING DEPTH OF STONE.
  11. DO NOT WASH OUT CONCRETE TRUCKS NEAR ANY EXISTING CATCH BASINS. A WASHOUT AREA SHALL BE DIRECTED BY THE TOWN PROJECT MANAGER AND ALL HARDENED CONCRETE AND DEBRIS SHALL BE REMOVED AND DISPOSED OF OFF SITE BY THE CONTRACTOR, AT THEIR OWN EXPENSE.
- EXISTING TREE PROTECTION**
- THE FOLLOWING NOTES WILL PERTAIN TO ANY AND ALL EXISTING TREES ON THE SITE, LOCATED WITHIN THE CONSTRUCTION AREA OR ADJACENT TO ANY CONSTRUCTION OPERATIONS AS A RESULT OF WORK BEING PERFORMED.
12. PRIOR TO ANY DEMOLITION OR CONSTRUCTION, PROTECT ALL TREES TO REMAIN AS DIRECTED THE PROJECT MANAGER OR BY ERECTING SNOW FENCE BEYOND THE DRIP LINE OR AS CLOSE AS POSSIBLE TO THE DRIP LINE TO THE SATISFACTION OF THE PROJECT MANAGER. DO NOT STORE OR STOCKPILE ANY BUILDING MATERIALS OR EQUIPMENT INSIDE THE DRIP LINE OF EXISTING TREES.
  13. IF RE-GRAVING IS REQUIRED BETWEEN THE DRIP LINE OF AN EXISTING TREE, DO NOT REMOVE OR ADD MORE THAN 100mm (4") OF SOIL. IF THE SITUATION REQUIRES A CHANGE IN GRADE OF MORE THAN 100mm (4") NOTIFY THE TOWN PROJECT MANAGER FOR FURTHER INSTRUCTION.
  14. DO NOT WRAP OR RIG CABLES AROUND OR IN ANY TREE.
  15. DO NOT FLUSH OR DISPOSE OF ANY CHEMICALS OR OTHER CONTAMINATES BETWEEN THE TRUNK OF THE TREE AND THE DIAMETER OF THE HEAD OF THE TREE. DO NOT WASH OFF VEHICLES OR TRUCKS NEAR OR UNDER THE DRIP LINE OF ANY TREE. VEHICLES OF ANY KIND MUST BE RINSED ON HARD SURFACE AREA SUCH AS STONE, ASPHALT, OR CONCRETE.
  16. WHERE LIMBS OR PORTIONS OF THE TREE AREA TO BE REMOVED AS A RESULT OF CONSTRUCTION WORK, CAREFULLY REMOVE THEM IN ACCORDANCE WITH ACCEPTED ARBORICULTURAL PRACTICE.
  17. ANY TREES DAMAGED AS A RESULT OF CONSTRUCTION BEYOND REPAIR MUST BE REPLACED TO THE SATISFACTION OF THE TOWN OF AMHERSTBURG, WITH NEW TREES HAVING A CALIPER NO LESS THAN 150mm (6"). THE CONTRACTOR SHALL NOTIFY THE TOWN PROJECT MANAGER AS SOON AS ANY DAMAGE HAS OCCURRED TO ANY EXISTING TREE.

DATE:	FEBRUARY 2025
ISSUED FOR:	TENDER

**TOWN OF AMHERSTBURG**  
PARKS, RECREATION, & FACILITIES

PROJECT: <b>JACK PURDIE PATHWAY RECONSTRUCTION</b>	PROJECT No.: <b>2025-003</b>										
<table border="1" style="width: 100%;"> <tr> <td style="width: 50%;">SHEET TITLE: <b>EXISTING CONDITIONS, DEMOLITION, and EXCAVATION PLAN</b></td> <td style="width: 50%;"></td> </tr> <tr> <td>SCALE: <b>N.T.S.</b></td> <td></td> </tr> <tr> <td>DRAWN BY: <b>S. P. H.</b></td> <td></td> </tr> <tr> <td>APPROVED BY: <b>H. B.</b></td> <td></td> </tr> <tr> <td>DATE: <b>MARCH 2025</b></td> <td>Sht No. <b>1 of 3</b></td> </tr> </table>		SHEET TITLE: <b>EXISTING CONDITIONS, DEMOLITION, and EXCAVATION PLAN</b>		SCALE: <b>N.T.S.</b>		DRAWN BY: <b>S. P. H.</b>		APPROVED BY: <b>H. B.</b>		DATE: <b>MARCH 2025</b>	Sht No. <b>1 of 3</b>
SHEET TITLE: <b>EXISTING CONDITIONS, DEMOLITION, and EXCAVATION PLAN</b>											
SCALE: <b>N.T.S.</b>											
DRAWN BY: <b>S. P. H.</b>											
APPROVED BY: <b>H. B.</b>											
DATE: <b>MARCH 2025</b>	Sht No. <b>1 of 3</b>										

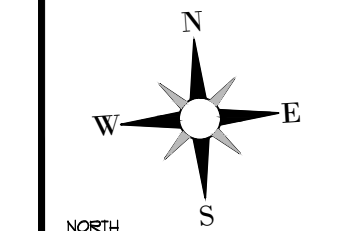



**LEGEND**

- RESTORE WITH EXCAVATED TOPSOIL & HYDROSEED
- PROPOSED 3m WIDE ASPHALT PATHWAY
- PROPOSED 2.5m WIDE CONCRETE SIDEWALK ON SOUTH SIDE OF NORTH PARKING LOT

- GENERAL NOTES**
- CONTRACTOR TO CALL FOR LOCATES PRIOR TO COMMENCEMENT OF ANY WORK ON SITE. CONTRACTOR TO DETERMINE AND VERIFY THE LOCATION AND EXISTENCE OF ALL UNDERGROUND UTILITIES PRIOR TO COMMENCING CONSTRUCTION. ADVISE THE PROJECT MANAGER OF ANY CONFLICTS BETWEEN EXISTING UTILITIES AND NEW WORK.
  - THE LOCATION OF UTILITIES, IF INDICATED ON THE DRAWING IS NOT CERTIFIED TO BE ACCURATE. THE OWNER LIES ON THE CONTRACTOR AFTER ACCEPTANCE OF ANY CONTRACT AWARD, TO OBTAIN AT THEIR OWN EXPENSE, THE EXACT LOCATION OF EACH UTILITY. NO EXTRA'S TO THE CONTRACTOR OR CLAIM FOR COMPENSATION WILL BE ALLOWED IF IT SHOULD BE DISCOVERED THAT ANY UTILITY IS ACTUALLY LOCATED IN THE SITE, LINE OR GRADE THAT IS IN VARIANCE WITH THE SITE, LINE OR GRADE SHOWN ON THIS DRAWING.
  - CONTRACTOR TO INFORM THE TOWN OF AMHERSTBURG PROJECT MANAGER OF COMMENCEMENT OF WORK, DATE AND TIME OF WORK START UP, PRIOR TO ANY ON SITE OPERATIONS TAKING PLACE. THE TOWN'S PROJECT MANAGER WILL MEET THE CONTRACTOR ON SITE TO REVIEW ALL WORK PRIOR TO COMMENCEMENT. A MINIMUM OF 48 HOURS NOTICE SHALL BE GIVEN TO THE TOWN PRIOR TO STARTING ANY WORK.
  - THE CONTRACTOR SHALL VERIFY ALL PROPOSED FINISHED GRADES, INCLUDING OF ASPHALT, CONCRETE, INVERTS, CATCH BASINS, AND MANHOLE TOPS. CONTRACTOR SHALL ENSURE POSITIVE DRAINAGE WITH SLOPES INDICATED ON DRAWINGS. WHERE SLOPES ARE NOT INDICATED, CONTRACTOR SHALL CONSULT WITH THE TOWN ON SITE TO DETERMINE APPROPRIATE GRADE. CONTRACTOR TO OBTAIN ALL PERMITS REQUIRED FOR ANY DRAINAGE WORK, IF NECESSARY.
  - CONTRACTOR SHALL REPAIR, AT THEIR OWN EXPENSE, ANY DAMAGE CAUSED AS A RESULT OF CONSTRUCTION. VERIFY THAT ALL EXISTING SITE CONDITIONS ARE AS SHOWN ON THE PLANS. THE CONTRACTOR IS RESPONSIBLE TO THE TOWN FOR ANY DAMAGE DONE TO A UTILITY THROUGH ANY ACT OF NEGLIGENCE BY THE CONTRACTOR OR ANYONE ACTING UNDER THE AUTHORITY OF THE CONTRACTOR.
  - ALL WORK PERFORMED SHALL BE IN COMPLIANCE WITH THE HEALTH AND SAFETY ACT, LATEST REVISIONS, AS WELL AS THE TOWN OF AMHERSTBURG HEALTH AND SAFETY POLICIES AND PROCEDURES.
  - ALL NEW CONCRETE BARRIER CURES TO CONFORM WITH THE TOWN OF AMHERSTBURG STANDARDS, AND AS PER DRAWINGS. ALL CONCRETE WORK TO CONFORM WITH THE TOWN OF AMHERSTBURG STANDARDS. ALL SLOPES MUST MEET OR EXCEED TOWN OF AMHERSTBURG FADS AND ACDA REGULATIONS.
  - RESTORATION OF ANY AREAS DISTURBED AS A RESULT OF CONSTRUCTION WILL BE THE RESPONSIBILITY OF THE CONTRACTOR TO RESTORE TO ORIGINAL CONDITIONS OR BETTER, INCLUDING ASPHALT, CONCRETE, CURBS, GRASS OR ANY OTHER SITE FEATURE DAMAGED AS A RESULT OF CONTRACTOR OPERATIONS. GRASS AREAS TO BE RESTORED WITH FINE GRADED TOPSOIL AND HYDROSEED AS PER SPECIFICATIONS.
  - GRADES AND DIMENSIONS ARE PROVIDED FOR CONVENIENCE TO BIDDER AND ARE THE RESPONSIBILITY OF THE CONTRACTOR TO PROVIDE OR VERIFY WITH THE TOWN PROJECT MANAGER.
  - CONTRACTOR TO PROVIDE SITE LAYOUT SERVICES BY CERTIFIED SURVEYOR TO CONFORM WITH DRAWINGS AND CAD FILES PROVIDED BY THE TOWN. GRADES AND DEPTH MUST BE CONFIRMED BY THE TOWN PROJECT MANAGER PRIOR TO POURING ANY CONCRETE, PLACEMENT OF ASPHALT, OR FINALIZING DEPTH OF STONE.
  - DO NOT WASH OUT CONCRETE TRUCKS NEAR ANY EXISTING CATCH BASINS. A WASHOUT AREA SHALL BE DIRECTED BY THE TOWN PROJECT MANAGER AND ALL HARDENED CONCRETE AND DEBRIS SHALL BE REMOVED AND DISPOSED OF OFF SITE BY THE CONTRACTOR, AT THEIR OWN EXPENSE.
- EXISTING TREE PROTECTION**
- THE FOLLOWING NOTES WILL PERTAIN TO ANY AND ALL EXISTING TREES ON THE SITE, LOCATED WITHIN THE CONSTRUCTION AREA OR ADJACENT TO ANY CONSTRUCTION OPERATIONS AS A RESULT OF WORK BEING PERFORMED.
- PRIOR TO ANY DEMOLITION OR CONSTRUCTION, PROTECT ALL TREES TO REMAIN AS DIRECTED THE PROJECT MANAGER OR BY ERECTING SNOW FENCE BEYOND THE DRIP LINE OR AS CLOSE AS POSSIBLE TO THE DRIP LINE TO THE SATISFACTION OF THE PROJECT MANAGER. DO NOT STORE OR STOCKPILE ANY BUILDING MATERIALS OR EQUIPMENT INSIDE THE DRIP LINE OF EXISTING TREES.
  - IF RE-GRADING IS REQUIRED BETWEEN THE DRIP LINE OF AN EXISTING TREE, DO NOT REMOVE OR ADD MORE THAN 100mm (4") OF SOIL. IF THE SITUATION REQUIRES A CHANGE IN GRADE OF MORE THAN 100mm (4") NOTIFY THE TOWN PROJECT MANAGER FOR FURTHER INSTRUCTION.
  - DO NOT WRAP OR RIG CABLES AROUND OR IN ANY TREE.
  - DO NOT FLUSH OR DISPOSE OF ANY CHEMICALS OR OTHER CONTAMINATED BETWEEN THE TRUNK OF THE TREE AND THE DIAMETER OF THE HEAD OF THE TREE. DO NOT WASH OFF VEHICLES OR TRUCKS NEAR OR UNDER THE DRIP LINE OF ANY TREE. VEHICLES OF ANY KIND MUST BE RINSED ON HARD SURFACE AREA SUCH AS STONE, ASPHALT, OR CONCRETE.
  - WHERE LIMBS OR PORTIONS OF THE TREE AREA TO BE REMOVED AS A RESULT OF CONSTRUCTION WORK, CAREFULLY REMOVE THEM IN ACCORDANCE WITH ACCEPTED ARBORICULTURAL PRACTICE.
  - ANY TREES DAMAGED AS A RESULT OF CONSTRUCTION BEYOND REPAIR MUST BE REPLACED TO THE SATISFACTION OF THE TOWN OF AMHERSTBURG, WITH NEW TREES HAVING A CALIPER NO LESS THAN 150mm (6"). THE CONTRACTOR SHALL NOTIFY THE TOWN PROJECT MANAGER AS SOON AS ANY DAMAGE HAS OCCURRED TO ANY EXISTING TREE.

DATE:	FEBRUARY 2025
ISSUED FOR:	TENDER

**TOWN OF AMHERSTBURG**  
PARKS, RECREATION, & FACILITIES

PROJECT: **JACK PURDIE PATHWAY RECONSTRUCTION** PROJECT No.: **2025-003**

SHEET TITLE: **NEW PATHWAYS LAYOUT PLAN**

SCALE: N.T.S.

DRAWN BY: S. P. H.

APPROVED BY: H. B.

DATE: MARCH 2025 SHEET No: 2 of 3

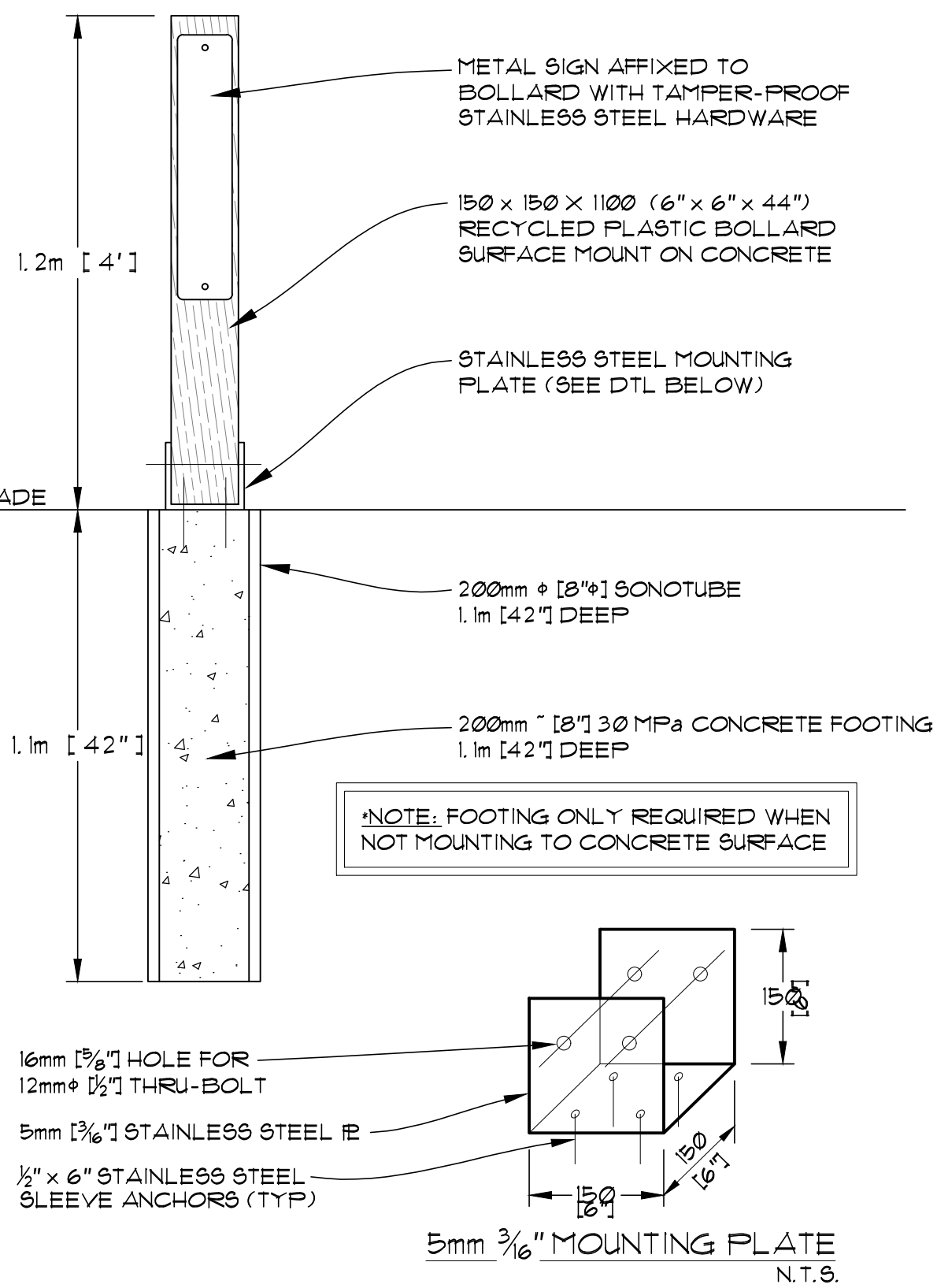

**RECYCLED PLASTIC BOLLARD**  
N.T.S.

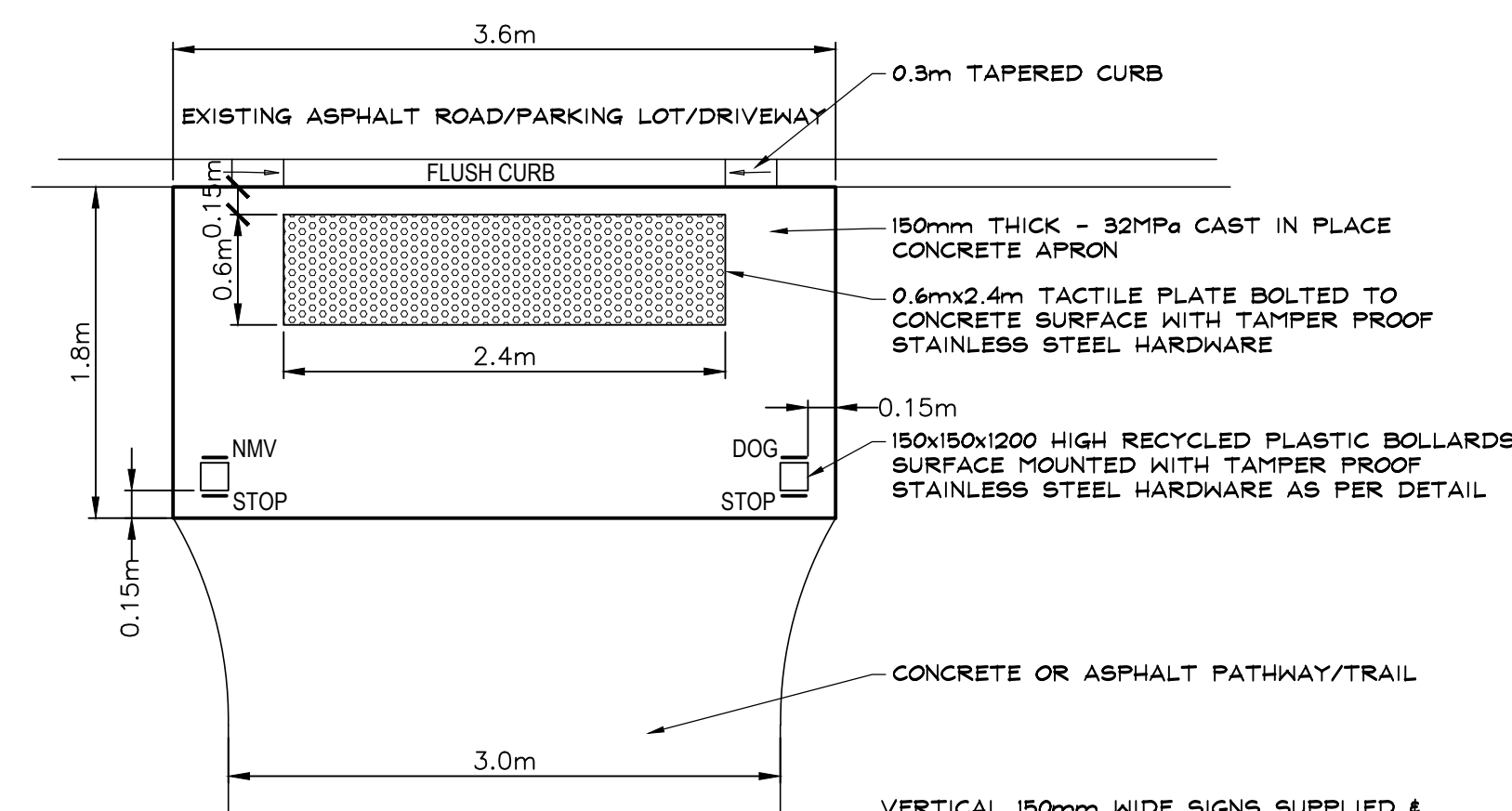

**NOTE:**  
THIS DETAIL SHALL BE READ IN CONJUNCTION WITH 'RECYCLED PLASTIC BOLLARD' DETAIL, AND; ELEVATIONS TO MATCH EXISTING OR AS INDICATED ON ANY APPLICABLE PROJECT GRADING PLAN OR AS DIRECTED BY PROJECT MANAGER

VERTICAL 150mm WIDE SIGNS SUPPLIED & INSTALLED BY TOWN OF AMHERSTBURG:  
STOP - STOP SIGN (2)  
NMV - NO MOTORIZED VEHICLES (1)  
DOG - LEASH, STOOP & SCOOP (1)

**TACTILE PLATE AT VEHICLE CROSSING**  
N.T.S.

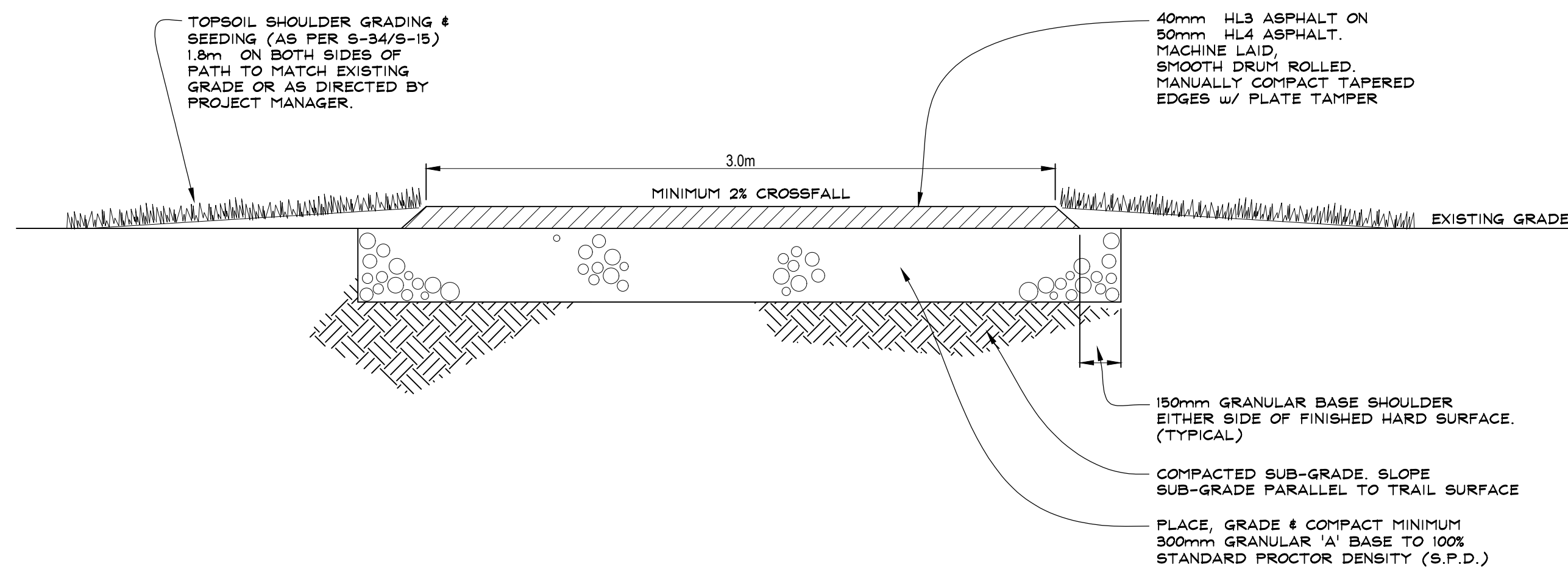

**SECTION THRU ASPHALT PATHWAY**  
N.T.S.

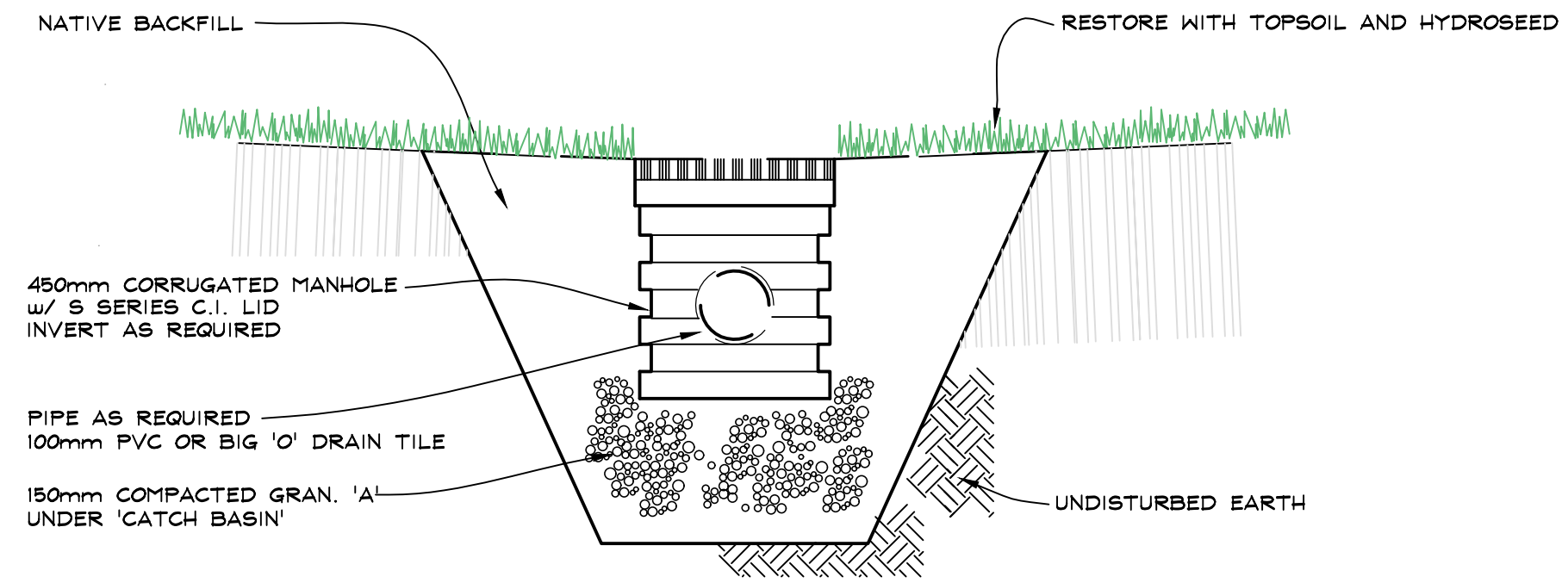

**DRAINAGE CROSS SECTION**  
N.T.S.

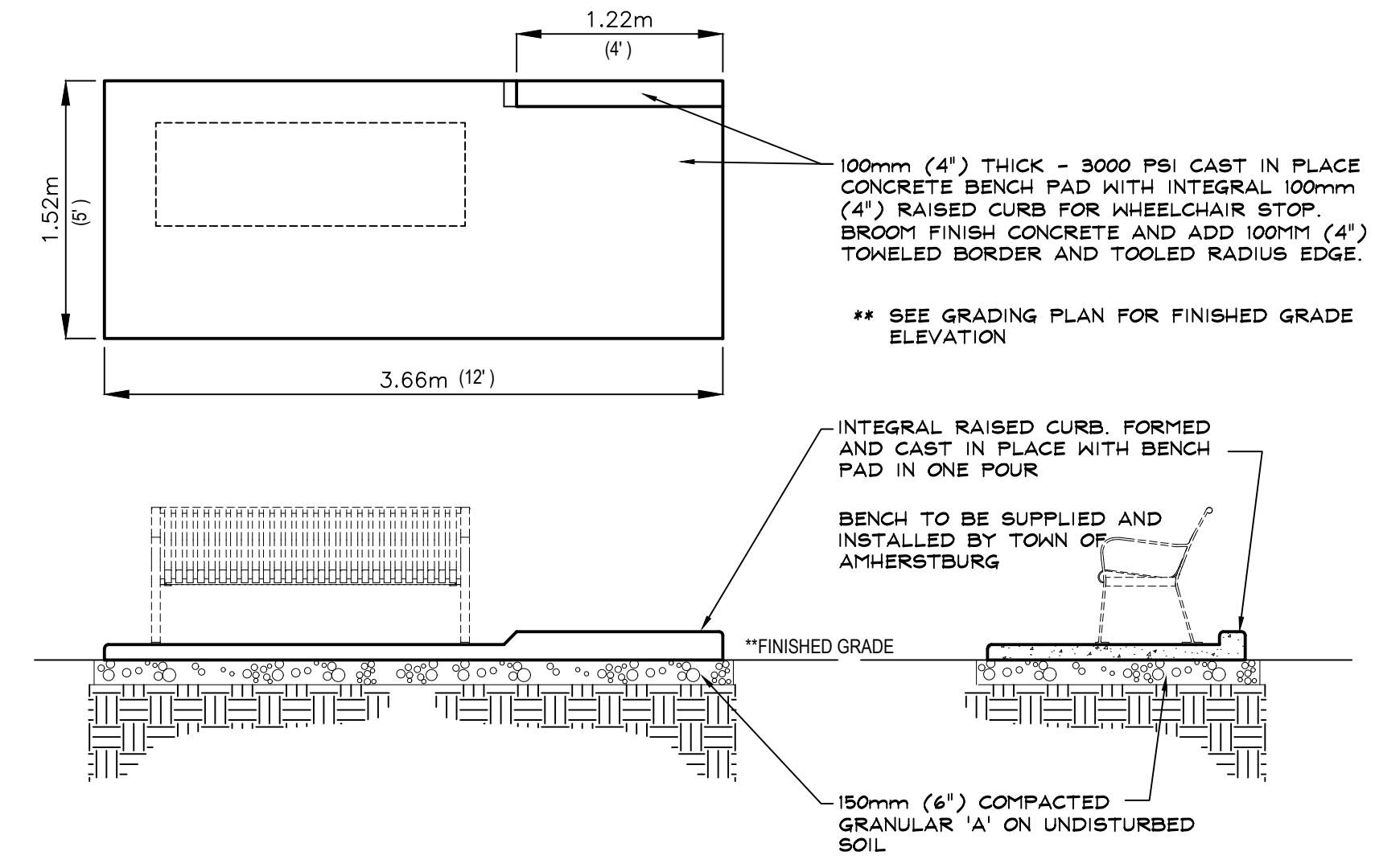

**SECTION THRU CONCRETE BENCH PAD**  
N.T.S.

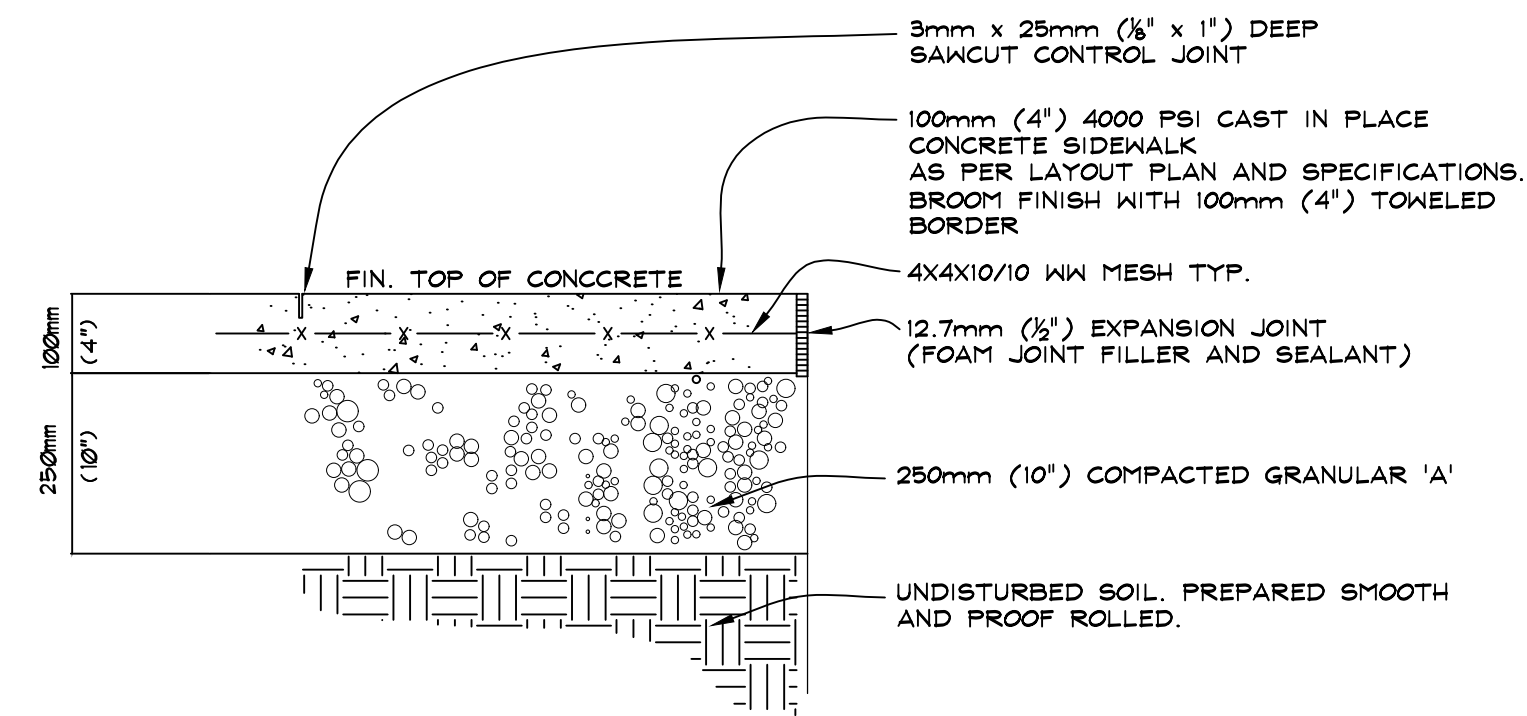

**NOTE:**  
PROVIDE SAWCUT CONTROL JOINTS AT MAX. 1.5m (5') O.C. LOCATIONS OF SAWCUTS TO BE CONFIRMED ON SITE BY PROJECT MANAGER.  
PROVIDE EXPANSION JOINTS WHERE SIDEWALK ABUTS A RIGID SURFACE OR CHANGES DIRECTION.  
EXPANSION JOINTS TO BE FULL DEPTH FIBRE BOARD OR FOAM WITH SEALANT.

**SECTION THRU CONCRETE SIDEWALK**  
N.T.S.

**GENERAL NOTES**

- CONTRACTOR TO CALL FOR LOCATES PRIOR TO COMMENCEMENT OF ANY WORK ON SITE. CONTRACTOR TO DETERMINE AND VERIFY THE LOCATION AND EXISTENCE OF ALL UNDERGROUND UTILITIES PRIOR TO COMMENCING CONSTRUCTION. ADVISE THE PROJECT MANAGER OF ANY CONFLICTS BETWEEN EXISTING UTILITIES AND NEW WORK.
  - THE LOCATION OF UTILITIES, IF INDICATED ON THE DRAWING IS NOT CERTIFIED TO BE ACCURATE. THE OWNER LIES ON THE CONTRACTOR AFTER ACCEPTANCE OF ANY CONTRACT AWARD. TO OBTAIN AT THEIR OWN EXPENSE, THE EXACT LOCATION OF EACH UTILITY. NO EXTRA TO THE CONTRACTOR CLAIM FOR COMPENSATION WILL BE ALLOWED IF IT SHOULD BE DISCOVERED THAT ANY UTILITY IS ACTUALLY LOCATED IN THE SITE, LINE OR GRADE THAT IS IN VARIANCE WITH THE SITE, LINE OR GRADE SHOWN ON THIS DRAWING.
  - CONTRACTOR TO INFORM THE TOWN OF AMHERSTBURG PROJECT MANAGER OF COMMENCEMENT OF WORK, DATE AND THE OF WORK START UP, PRIOR TO ANY ON SITE OPERATIONS TAKING PLACE. THE TOWN'S PROJECT MANAGER WILL MEET THE CONTRACTOR ON SITE TO REVIEW ALL WORK PRIOR TO COMMENCEMENT. A MINIMUM OF 48 HOURS' NOTICE SHALL BE GIVEN TO THE TOWN PRIOR TO STARTING ANY WORK.
  - THE CONTRACTOR SHALL VERIFY ALL PROPOSED FINISHED GRADES, INCLUDING OF ASPHALT, CONCRETE, INVERTS, CATCH BASINS, AND MANHOLE TOP ELEVATIONS. CONTRACTOR SHALL ENSURE POSITIVE DRAINAGE WITH SLOPES INDICATED ON DRAWINGS. WHERE SLOPES ARE NOT INDICATED, CONTRACTOR SHALL CONSULT WITH THE TOWN ON SITE TO DETERMINE APPROPRIATE GRADE. CONTRACTOR TO OBTAIN ALL PERMITS REQUIRED FOR ANY DRAINAGE WORK, IF NECESSARY.
  - CONTRACTOR SHALL REPAIR, AT THEIR OWN EXPENSE, ANY DAMAGE CAUSED AS A RESULT OF CONSTRUCTION. VERIFY THAT ALL EXISTING SITE CONDITIONS ARE AS SHOWN ON THE PLANS. THE CONTRACTOR IS RESPONSIBLE TO THE TOWN FOR ANY DAMAGE DONE TO A UTILITY THROUGH ANY ACT OF NEGLIGENCE BY THE CONTRACTOR OR ANYONE ACTING UNDER THE AUTHORITY OF THE CONTRACTOR.
  - ALL WORK PERFORMED SHALL BE IN COMPLIANCE WITH THE TOWN OF AMHERSTBURG HEALTH AND SAFETY POLICIES AND PROCEDURES.
  - ALL NEW CONCRETE BARRIER CURBS TO CONFORM WITH THE TOWN OF AMHERSTBURG STANDARDS, AND AS PER DRAWINGS. ALL CONCRETE WORK TO CONFORM WITH THE TOWN OF AMHERSTBURG STANDARDS. ALL SLOPES MUST MEET OR EXCEED TOWN OF AMHERSTBURG FADS AND ACDA REGULATIONS.
  - RESTORATION OF ANY AREAS DISTURBED AS A RESULT OF CONSTRUCTION WILL BE THE RESPONSIBILITY OF THE CONTRACTOR TO RESTORE TO ORIGINAL CONDITION OR BETTER, INCLUDING ASPHALT, CONCRETE, CURBS, GRASS OR ANY OTHER SITE FEATURE DAMAGED AS A RESULT OF CONTRACTOR OPERATIONS. GRASS AREAS TO BE RESTORED WITH FINE GRADED TOPSOIL AND HYDROSEED AS PER SPECIFICATIONS.
  - GRADES AND DIMENSIONS ARE PROVIDED FOR CONVENIENCE TO BIDDERS AND ARE THE RESPONSIBILITY OF THE CONTRACTOR TO PROVIDE OR VERIFY WITH THE TOWN PROJECT MANAGER.
  - CONTRACTOR TO PROVIDE SITE LAYOUT SERVICES BY CERTIFIED SURVEYOR TO CONFORM WITH DRAWINGS AND CAD FILES PROVIDED BY THE TOWN. GRADES AND DEPTH MUST BE CONFIRMED BY THE TOWN PROJECT MANAGER PRIOR TO POURING ANY CONCRETE, PLACEMENT OF ASPHALT, OR FINALIZING DEPTH OF STONE.
  - DO NOT WASH OUT CONCRETE TRUCKS NEAR ANY EXISTING CATCH BASINS. A WASHOUT AREA SHALL BE DIRECTED BY THE TOWN PROJECT MANAGER AND ALL HARDENED CONCRETE AND DEBRIS SHALL BE REMOVED AND DISPOSED OF OFF SITE BY THE CONTRACTOR, AT THEIR OWN EXPENSE.
- EXISTING TREE PROTECTION**  
THE FOLLOWING NOTES WILL PERTAIN TO ANY AND ALL EXISTING TREES ON THE SITE, LOCATED WITHIN THE CONSTRUCTION AREA, OR ADJACENT TO ANY CONSTRUCTION OPERATIONS AS A RESULT OF WORK BEING PERFORMED.
- PRIOR TO ANY DEMOLITION OR CONSTRUCTION, PROTECT ALL TREES TO REMAIN AS DIRECTED THE PROJECT MANAGER OR BY ERECTING SNOW FENCE BEYOND THE DRIP LINE OR AS CLOSE AS POSSIBLE TO THE DRIP LINE TO THE SATISFACTION OF THE PROJECT MANAGER. DO NOT STORE OR STOCKPILE ANY BUILDING MATERIALS OR EQUIPMENT INSIDE THE DRIP LINE OF EXISTING TREES.
  - IF RE-GRADING IS REQUIRED BETWEEN THE DRIP LINE OF AN EXISTING TREE, DO NOT REMOVE OR ADD MORE THAN 100mm (4") OF SOIL. IF THE SITUATION REQUIRES A CHANGE IN GRADE OF MORE THAN 100mm (4") NOTIFY THE TOWN PROJECT MANAGER FOR FURTHER INSTRUCTION.
  - DO NOT WRAP OR RIG CABLES AROUND OR IN ANY TREE.
  - DO NOT FLUSH OR DISPOSE OF ANY CHEMICALS OR OTHER CONTAMINATED BETWEEN THE TRUNK OF THE TREE AND THE DIAMETER OF THE HEAD OF THE TREE. DO NOT WASH OFF VEHICLES OR TRUCKS NEAR OR UNDER THE DRIP LINE OF ANY TREE. VEHICLES OF ANY KIND MUST BE RINSED ON HARD SURFACE AREA SUCH AS STONE, ASPHALT, OR CONCRETE.
  - WHERE LIMBS OR PORTIONS OF THE TREE AREA TO BE REMOVED AS A RESULT OF CONSTRUCTION WORK, CAREFULLY REMOVE THEM IN ACCORDANCE WITH ACCEPTED ARBORICULTURAL PRACTICE.
  - ANY TREES DAMAGED AS A RESULT OF CONSTRUCTION BEYOND REPAIR MUST BE REPLACED TO THE SATISFACTION OF THE TOWN OF AMHERSTBURG, WITH NEW TREES HAVING A CALIPER NO LESS THAN 150mm (6"). THE CONTRACTOR SHALL NOTIFY THE TOWN PROJECT MANAGER AS SOON AS ANY DAMAGE HAS OCCURRED TO ANY EXISTING TREE.

FEBRUARY 2025 TENDER  
DATE: ISSUED FOR:

**TOWN OF AMHERSTBURG**  
PARKS, RECREATION, & FACILITIES

PROJECT: **JACK PURDIE PATHWAY RECONSTRUCTION** PROJECT No.: **2025-003**

SHEET TITLE: **DETAILS**  
SCALE: N.T.S.  
DRAWN BY: S.P.H.  
APPROVED BY: H.B.  
DATE: MARCH 2025 SHE No: 3 of 3